

Brewer

Design Guide



For
Architects,
Designers,
Builders,
Planners

Table of Contents

PRODUCT OVERVIEW/FLOOR PLANS

LiftMate Low/High Mobile Patient Lift	3
Assist Power Procedure Table	4
Access High-Low Power Exam Table	6
FLEX Access Exam Table	7
Access Examination Table	9

OTHER BREWER PRODUCT LINES

Task Lighting Series	11
Exam Stools and Medical Seating	12-13
Additional Support Products	14

BREWER COLOR OPTIONS 16-17

Brewer offers many other products to complete the exam room, including IV poles, hampers, waste cans, utility carts, instrument stands, overhead bed tables, and step stools. Learn more about the complete offering by visiting brewercompany.com.



LiftMate™

Brewer Low/High Patient Lift

Protect your patients as well as your staff. Lift with your finger, not your back.



model

#3000 Brewer LiftMate™ Low/High
Mobile Patient Lift

Advanced Safety

- Large non-slip platform surface
- Two emergency stop buttons
- Grab bars for patient stability and positioning
- Four auto-lock rubber feet for stability
- Four retractable swivel casters prevent rolling during use
- Smooth movement for enhanced patient security
- Quiet actuators for patient comfort
- Large platform with ample room for patient positioning
- Easy access for walkers
- Designed to prevent patient falls
- Reduces need to assist patients onto exam tables

Dimensions

- Height: 38" - 47" (96.5 cm-119.4 cm)
- Depth (outer dimensions): 21.5" (54.6 cm)
- Width (outer dimensions): 34.75" (88.3 cm)
- Depth (platform): 18" (45.7 cm)
- Width (platform): 21.5" (54.6 cm)
- Width (between grab bars): 27.75" (70.5 cm)

Other Specifications

- Standard three-year warranty
- 500 lb (226 kg) weight capacity
- 115 VAC, 60 Hz
- Safe, extra-low voltage actuators
- Convenient hand pendant for easy operation
- Powered by standard outlet plug or rechargeable battery
- Fits through standard doorways

- **Helps prevent patient falls**
- **Improves clinical staff safety**
- **Removes patient mobility barriers**
- **Reduces capital investment**
- **Mobile, maneuverable and easy to use**

Lift with your finger, not your back.



BrewerAssist

POWER PROCEDURE TABLE

Advanced Safety

- Safety release actuators
- Safe extra-low voltage actuators
- 19" (48.3 cm) low height
- 40" (101.6 cm) maximum height
- Leg rest extends an additional 5" (12.7 cm)
- Adjustable three-point pivot headrest
- Easy-to-clean seamless upholstery
- 18" (45.7 cm) or 21" (53.3 cm) paper dispenser

Table Dimensions

- Height: 19" – 40" (48.3 cm – 101.6 cm)
- Length: 69" (175.3 cm)
- Length with headrest & leg rest extended: 80" (203.2 cm)
- Length in upright position: 40" (101.6 cm)
- Width: 28" (71.1 cm)
- Leg rest: 16.6" x 11.25" (42.2 cm x 27.9 cm)
- Headrest: 13" x 11" (33 cm x 27.9 cm)
- Tilt range / Trendelenburg: to 30°
- Base: 24" W x 36" L (61 cm x 91.4 cm)

Other Specifications

- 450 lb (204 kg) weight capacity
- Standard three-year warranty
- Standard adjustable stirrups
- Standard foot control
- Hand pendant standard on 7500 models
- 115 VAC, 60 Hz
- 12 standard upholstery color options
- CAL-133 fire resistant upholstery available in 4 colors
- Premium, plush upholstery available in 5 colors
- Custom colors available



models

#7000	Assist Power Procedure Table
#7500	AssistPRO Programmable Power Procedure Table

Make procedures easier, safer and more comfortable for staff and patients.

Brewer's Power Procedure Tables are infinitely adjustable to meet any procedure needs.



Supine



Left Lateral Plane

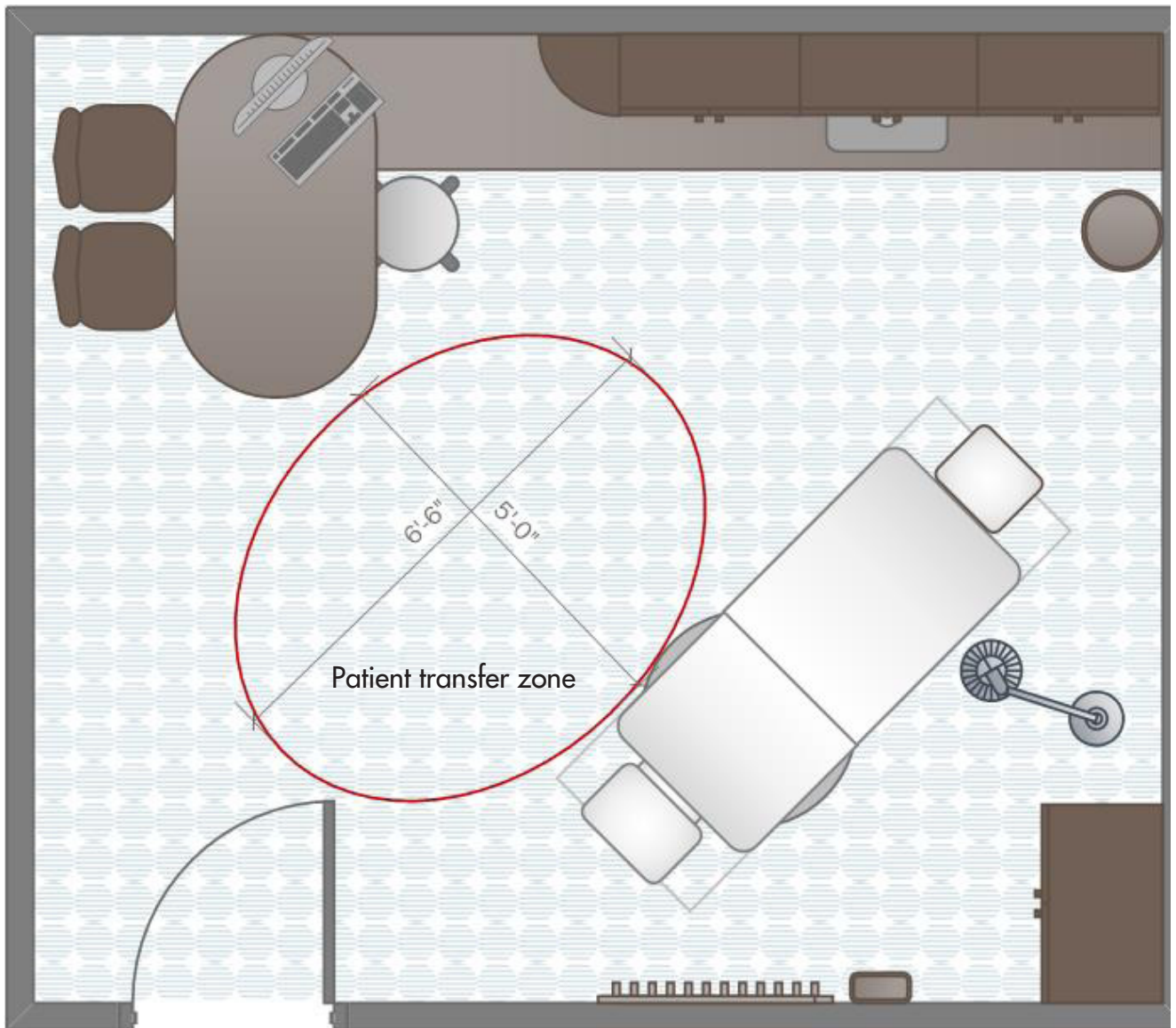


Lithotomy



Proctology

Brewer Assist Power Procedure Table Floor Plans & Work Flow



Room

168.0 in. x 144.0 in.

BrewerAccess

High-Low

EXAM TABLE

BrewerAccess

High-Low

EXAM TABLE

700

Advanced Safety

- Exclusive SafeGlide™ leg extension increases safety and satisfaction
- Safety grab bars for patient stability
- Return-to-chair feature on powered back models only
- On/off switch prevents accidental movement
- Sensors prevent injuries during table movement
- 18" low height, 28" when flat (45.7cm, 71.1 cm)
- Easy on/off for patients
- Powered backrest adjusts for easy positioning on 6500, 6501, 6800, and 6801 models

Abundant Storage

- Pass-through work surface on side of table
- Patented pass-through side drawers accessible from right or left side of the table
- Front drawer: 19.8"x19.2"x 3.8" (50.5 cm x 48.9 cm x 9.8 cm)
- Side drawers: 22.6"x 20.2"x 7" (57.5 cm x 51.4 cm x 17.8 cm)
- Covered storage for up to 6 paper rolls
- Paper storage capacity: 23"x23"x3.25" (58 cm x 58 cm x 8 cm)
- Slide through holder accepts 21" & 18" rolls (53.3 cm & 45.7 cm)

Table Dimensions

- Height: 18" - 37" (45.7 cm - 94 cm)
- Length: 57" extends to 78" (144.8cm-198.1cm)
- Upholstery width: 28" (71.1 cm)
- SafeGlide™ Leg extension length: 21" (53.3 cm)
- Goes flat at 28" (71.1 cm)

models

#6000	Access High-Low with pneumatic back
#6001	Access High-Low with pneumatic back, pelvic tilt, and front drawer warmer
#6500	Access High-Low with power back
#6501	Access High-Low with power back, pelvic tilt, front drawer warmer and outlet
#6800	Access High-Low 700lb weight capacity with power back
#6801	Access High-Low 700lb weight with power back, pelvic tilt, front drawer warmer and outlet

Other Specifications

- 450 lb (204 kg) & 700 lb (317 kg) weight capacities
- Standard patient assist grab bars
- Standard adjustable stirrups
- Standard foot control
- Standard three-year warranty
- 115VAC, 60 Hz
- Safe, low voltage actuators
- Safe, single power cord design, detachable
- Easy to clean, seamless upholstery
- 12 standard upholstery color options
- CAL-133 fire resistant upholstery available in 4 colors
- Premium, plush upholstery available in 5 colors
- Custom colors available



Pass-through Drawers



Patient Transfer Grab Bars and Pass-through Work Surface



Intuitive Controls



SafeGlide™

Brewer

FLEX ACCESS EXAM TABLE

Advanced Safety

- Exclusive SafeGlide™ leg extension increases patient and caregiver safety and satisfaction
- Return to chair feature - (5800 and 5801 models)
- Sensors minimize injuries during table movement
- ADA compliant at 18" seat height
- Easy on / off for patients

Patient Comfort

- Easy lateral wheelchair transfers

Large Front Drawer Storage

- Front drawer: 19.8" x 19.2" x 3.8" (50.3 cm x 48.8 cm x 9.7 cm)
- Front drawer storage can accommodate up to 6 - 18" x 3" paper rolls

Table Specifications

- 700 lb. (317 kg) weight capacity
- Height: 18" - 37" (45.7 cm - 94 cm)
- SafeGlide™ Leg extension length: 21" (53.3 cm)
- Standard foot control
- Standard 3-year warranty
- Standard easy to clean, seamless upholstery
- 12 standard upholstery color options
- CAL-133 fire resistant upholstery available in 4 colors
- Custom colors also available
- Length: 57" extends to 78" (144.8 cm - 198.1 cm)
- Upholstery width: 28" (71.1 cm)
- 115VAC, 60 Hz
- Safe, low voltage actuators
- Safe, single power cord design, detachable



models

- #5700 - FLEX Access Exam Table with pneumatic back
- #5701 - FLEX Access Exam Table with pneumatic back, pelvic tilt, front drawer heater and outlet
- #5800 - FLEX Access Exam Table with power back
- #5801 - FLEX Access Exam Table with power back, pelvic tilt, front drawer heater, and outlet

Optional Kits:

- #2102894: Ergonomic Stirrup for 5700 and 5800 (factory installed)
- #2102898: Ergonomic Stirrup for 5700 and 5800 (field installed)
- #2102893: Ergonomic Stirrup for 5701 and 5801 (factory installed)
- #2102897: Ergonomic Stirrup for 5701 and 5801 (field installed)
- #2102891: Safety Grab Bars (factory installed)

- #2102895: Safety Grab Bars (field installed)
- #2102892: Pass-through laptop work surface (factory installed)
- #2102896: Pass-through laptop work surface (field installed)



Optional Pass-through Laptop Work Surface



Optional Ergonomic Stirrups

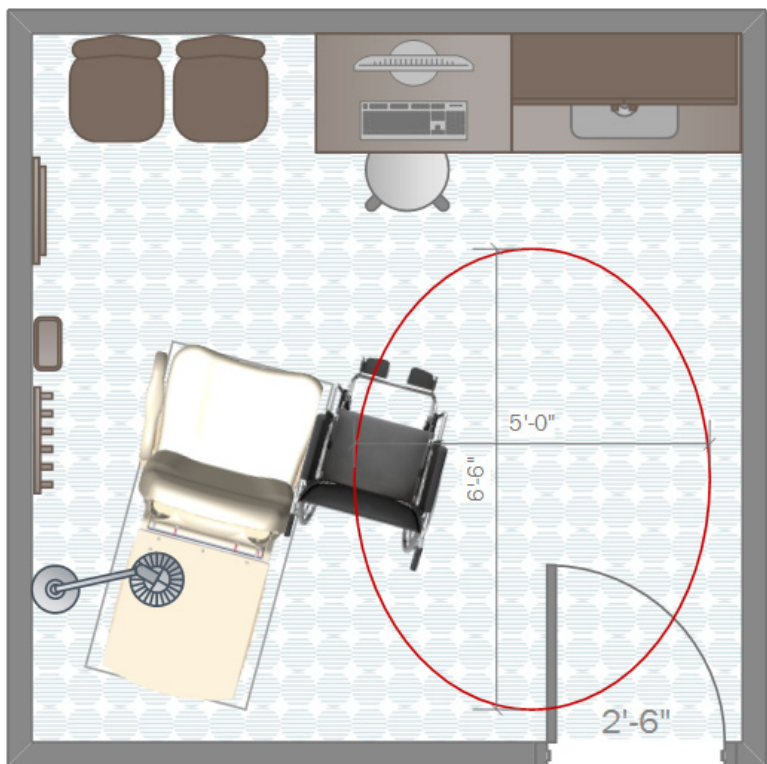


Optional Patient Transfer Grab Bars

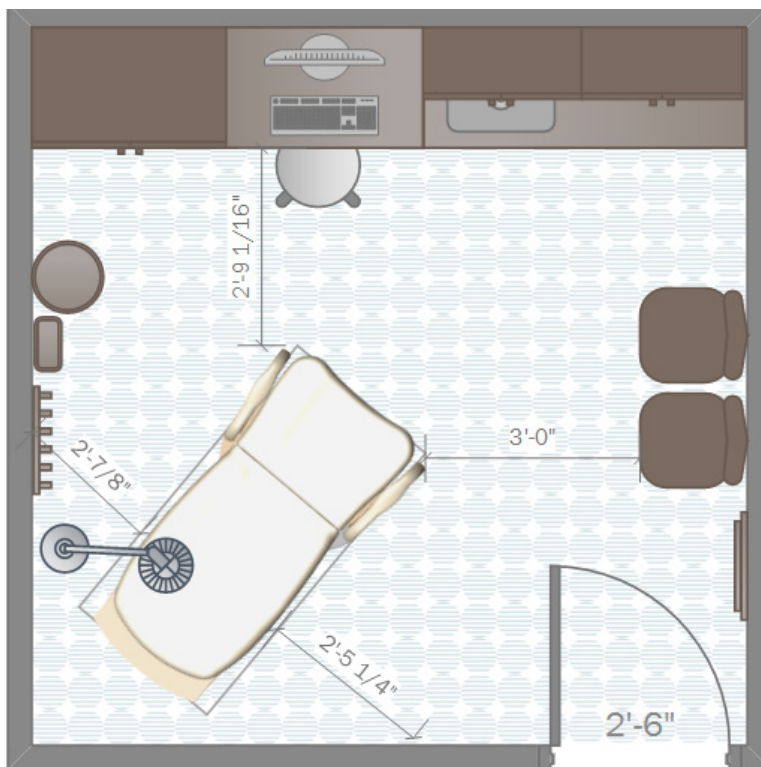


Table Position

Brewer Access High Low Exam Table and FLEX Access Exam Table Floor Plans & Work Flow



Room
10 ft. x 10 ft.



Room
10 ft. x 10 ft.



BrewerAccess

EXAM TABLE

Advanced Safety

- Stable four-leg patient step
- Largest step surface area available
- Simple pneumatic backrest for easy patient positioning

Abundant Storage

- Largest storage capacity available
- Patented pass-through side drawers accessible from right or left side
- Front drawer: 19.8"x19.2"x3.8" (50.5 cm x 48.9 cm x 9.8 cm)
- Side drawers: 22.6"x20.2"x 7" (57.5 cm x 51.4 cm x 17.8 cm)
- Slide through holder accepts 21" & 18" rolls (53.3 cm & 45.7 cm)
- Additional paper storage under backrest

Table Dimensions

- Height: 32" (81.3 cm)
- Length: 57.3" extends to 71" (145.5 cm - 180.3 cm)
- Width: 28" (71.1 cm)
- Leg extension length: 15" (38.1 cm)
- Step Dimensions: 20.4"W x 17.7"L x 8"H (51.8cm x 45 cm x 20.3cm)

Other Specifications

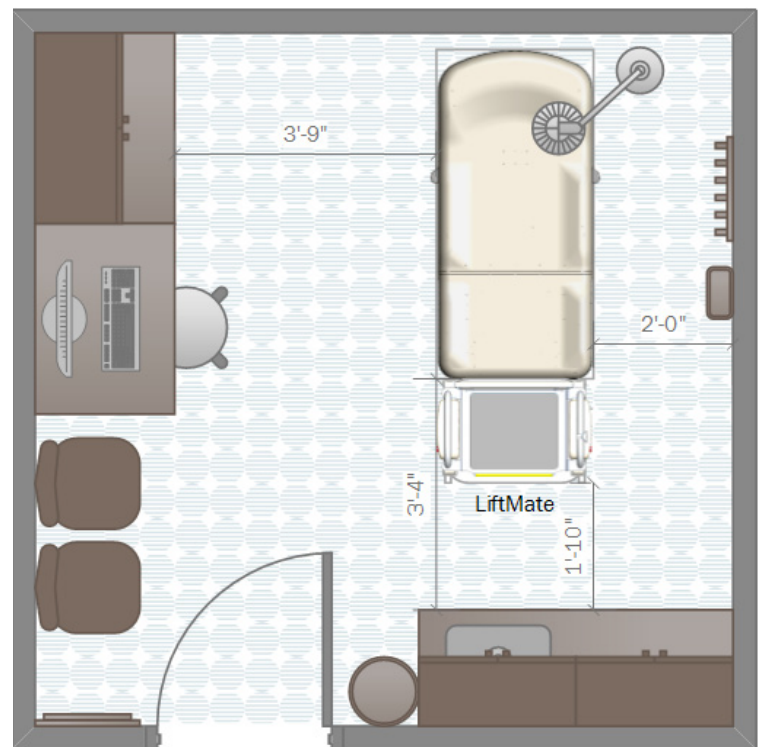
- 500 lb (226 kg) weight capacity
- Standard five-year warranty
- Standard adjustable stirrups
- 115VAC, 60Hz
- Easy-to-clean seamless upholstery
- 12 standard upholstery color options
- CAL-133 fire resistant upholstery available in 4 colors
- Custom colors available



models

#5000	Access Exam Table with pneumatic back
#5001	Access Exam Table with pneumatic back, pelvic tilt and drawer heater

Brewer Access Exam Table Floor Plans & Work Flow



Room
10 ft. x 10 ft.

LED ECO-SERIES

Light

- Bright, best-in-class white light drives clinical efficiency
- Cool to the touch and easy to maneuver
- 6" long, 5" dia., tri-lobed face
- Maximum 170° left/right head rotation
- 12-Watt LED bulb included
- Color temperature - 4000° Kelvin
- 8800 Lumens; 5" Beam Dia. at 18"
- Bulb life: 50,000 hrs

Arm

- Flexible, "no-drift," 23" (50.4 cm) gooseneck
- Maximum Height: 66" (167.6 cm)
- Smooth, easy-to-clean

Base

- Detachable power cord exits the weighted base at floor level
- Optional five-caster base
- Base Diameter: 13" (33 cm)
- Cord length: 10' (304.8 cm)

#19100 beige

accessories

#200165 five-caster base - beige



HALOGEN 35 SERIES

Light

- Crisp white light
- Non-metallic head eliminates surface heat
- Dichroic film-coated reflectors filter out 80% of beam heat
- Heat sink technology removes bulb socket heat and keeps the housing cool
- High intensity, low voltage 35-Watt bulb included
- Color temperature - 3000° Kelvin
- 1500 Footcandles @ 24" (61 cm)
- Bulb life: 4000 hrs

Arm

- Flexible, "no-drift," 24" (61 cm) gooseneck
- 540° rotation of light head and gooseneck arm
- Maximum Height: 65.5" (166.4 cm)

Base

- Internal power cord exits the weighted base at floor level
- Optional five-caster base
- Base Diameter: 13" (33 cm)
- Cord length: 9' 3" (281.9 cm)

#18100 beige

accessories

#001635 35-Watt replacement bulb

#200165 five-caster base - beige



INCANDESCENT SERIES

Light

- Advanced reflector system provides shadow-free, crisp white light
- Non-metallic head eliminates surface heat
- 25-Watt incandescent bulb included
- Bulb life: 500 hrs

Base

- Internal power cord exits the weighted base at floor level
- Optional five-caster base
- Base Diameter: 13" (33 cm)
- Cord length: 9' 3" (281.9 cm)

#17100 beige

Arm

- Flexible, "no-drift," 18" (45.7 cm) gooseneck offers superior beam alignment
- 540° rotation of light head and gooseneck arm
- Maximum Height: 62" (157.5 cm)

accessories

#001525 25-Watt replacement bulb

#200165 five-caster base - beige



CHROME SERIES

Light

- 10 to 40-Watt incandescent bulb (not included)

Arm

- Durable chrome finish
- 11" (27.9 cm) gooseneck
- Maximum Height: 72" (182.9 cm)
- 360° adjustment

Base

- Stable chrome plated base
- Base Diameter: 11" (27.9 cm)
- Grounded 3-wire plug
- Cord length: 12' (365.8 cm)

Some assembly is required

#11500 chrome



All Brewer products conform to US and Canadian electrical and medical industry codes and regulations and meet or exceed industry requirements.

SIDE CHAIRS

SERIES

Comfort. Reliability. Durability.

Chair Specifications

- Perfect for the exam room, front office or waiting room environment
- Kick-out leg design helps prevent wall dings and dents
- Comfortable, 2" (5.1 cm) thick poly-foam seat cushion
- Seat 18" x 18" (45.7 cm x 45.7 cm)
- Contoured backrest 18" x 13.38" (45.7 cm x 34 cm)
- Premium, plush upholstery available in 5 colors
- Black plastic backrest shroud for easy cleaning
- Durable steel tube frame
- Weight capacity: 250 lb (113 kg)
- Standard five-year warranty
- 12 standard upholstery color options
- Meets BIFMA (Business and Institutional Furniture Manufacturer's Association) Standards

Model with arms:

- Sturdy plastic arm rests
- Inside arm width: 20" (50.8 cm)
- Outside arm width: 23" (58.4 cm)



BLOOD DRAWING CHAIR

SERIES

Comfort. Adjustability. Durability.

Patient Comfort

- 2" (5.1 cm) thick poly-foam seat cushion
- Seat alignment positions patients securely on chair
- Innovative angled armrests allow optimal arm position for blood drawing
- Contoured, seamless upholstery for easy cleaning
- 12 standard upholstery color options
- Custom colors available

Chair Specifications

- Weight capacity: 350 lb (158 kg) weight capacity
- Standard five-year warranty
- Durable, powder-coated welded steel tube frame
- Two standard add-on work surfaces to accommodate prep materials, paperwork, and vials; 8" L x 12" W (20.3 cm x 30.5 cm)
- Work surfaces are easily removable to accommodate space constraints
- Taper-lock armrest knob adjustment system ensures smooth movement
- Optional drawer attaches on either side of chair; #101059
- Work surfaces covered in a bacteriological, chemical, and fungal resistant material
- Meets BIFMA (Business and Institutional Furniture Manufacturer's Association) standards

Chair Dimensions

- Height: 37" (94 cm)
- Length: 23.5" (59.7 cm)
- Width: 20" (50.8 cm), 29.25" (74.3 cm) with armrests, 43.25" (109.9 cm) with both work surfaces
- Floor to top of seat: 22" (55.9 cm)
- Chair depth: 23.5" (59.7 cm)
- Armrest Angle: 15°
- Armrest Height: 29.5" - 38" (74.9 cm - 96.5 cm)
- Seat cushion: 18" x 18" (45.7 cm x 45.7 cm)
- Backrest cushion: 18" x 12.5" (45.7 cm x 31.8 cm)



OPTIONAL BLOOD DRAWING CHAIR DRAWER

Drawer Specifications

- Easily attaches to either side of chair
- Work surfaces covered in a bacteriological, chemical, and fungal resistant material
- Interior plastic lining for easy cleaning

Drawer Dimensions

- Height: 4" (10.2 cm)
- Width: 7" (17.8 cm)
- Length: 10" (25.4 cm)



MILLENNIUM SERIES

Premium specialty seating with ergonomic design.

Millennium Series Stool Specifications

- 18.5" (47 cm) wide contoured seat cushion
- Adjustable contoured backrest with black plastic shroud, excl. #21340 & #21340V
- 2" (5.1 cm) dual-wheel nylon casters with polyurethane tread; locking caster optional
- 23" (58.4 cm) five leg powder coated black aluminum base
- Ergonomic design; seamless upholstery standard, excl. #21340
- 55 standard upholstery color options
- Weight capacity: 250 lb (113 kg)
- Standard five-year warranty

accessories for millennium series:

#2102265 Set of 5 pressurized locking casters

B - backrest
V* - vacuum formed
A - arm rests



TASK

- Pneumatic height adjustment: 18" - 24.75" (48.7 cm - 62.9 cm)
- Fully adjustable forward seat tilt
- Adjustable backrest with synchronized traversing movement of seat



#21435BA
w/ arm rests

#21435B
w/o arm rests

LAB

- Pneumatic height adjustment:
Glides: 20.75" - 31" (52.7 cm - 78.7 cm)
Casters: 21.75" - 32" (55.2 cm - 81.3 cm)
- 18" (48.7 cm) foot ring standard



#21520B w/glides
#21521B w/casters

SURGEON

- Hands-free foot pneumatic height adjustment: 19" - 24" (48.3 cm - 61 cm)
- 18.5" (47 cm) poly-foam seat cushion on 21340B only; 16" (40.6 cm) wide on 21340
- Seamless upholstery not standard on 21340



#21340B
#21340BV

#21340
#21340V

CENTURY SERIES

Preferred by medical facilities worldwide.

Century Series Stool Specifications

- 16" (40.6 cm) wide, 4" (10.2 cm) thick poly-foam seat cushion
- Pneumatic height adjustment; two heights available: 17.75" - 24.5" (45.1 cm - 62.2 cm); 20" - 27.5" (50.8 cm - 69.9 cm)
- Five-leg, 23" (58.4 cm) brushed aluminum accent base
- Chrome hooded, dual wheel casters; locking casters (LCD) and glides (G) available
- Optional adjustable contoured backrest with black plastic shroud
- Adjustable 18" (48.7 cm) foot ring standard on higher height models
- 55 standard upholstery color options
- CAL-133 fire resistant upholstery available in 4 colors (-C133)
- Premium, plush upholstery available in 5 colors (-UL)
- Weight capacity: 250 lb (113 kg)
- Standard five-year warranty

#11001BFR
in Cabernet



VALUE PLUS SERIES

Affordable without compromising style and reliability.



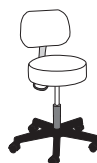
Value Plus Series Stool Specifications

- 15" (38.1 cm) wide, 4" (10.2 cm) thick poly-foam seat cushion
- Pneumatic or spinlift height adjustment
- Five-leg, 21" (53.3 cm) black ABS plastic composite base
- 2" (5.1 cm) black plastic dual-wheel nylon casters
- Optional adjustable contoured backrest with black plastic shroud
- 55 standard upholstery color options
- CAL-133 fire resistant upholstery 4 colors, for 22500 models

B - backrest
V* - vacuum formed
C133 - Cal 133 upholstery

height range

17" - 21.25"
(43.2 cm - 54 cm)



#22500B

#22500BV

#22500B-C133



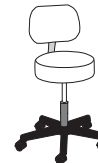
#22500

#22500V

#22500-C133

pneumatic
height adjustment

17" - 21.25"
(43.2 cm - 54 cm)



#22400B

#22400BV



#22400

#22400V

spinlift
height adjustment



TRADITION SERIES

Economical exam stools that stand the test of time.

Tradition Series Stool Specifications

- 14" (38.1 cm) wide, 3.5" (10.2 cm) thick poly-foam seat cushion
- Spinlift height adjustment
- Sturdy four-leg, 19.5" (49.5 cm) chrome base
- 2" (5.1 cm) rubber wheel, ball bearing casters
- 55 standard upholstery color options
- Standard five-year warranty

height range

19.5" - 27.5"
(49.5 cm - 69.9 cm)

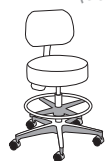


#23051

spinlift
height adjustment

height range

20" - 27.5"
(50.8 cm - 69.6 cm)



#11001BFR

#11001BVFR

#11001BFR-C133

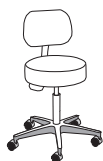


#11001FR

#11001VFR

#11001FR-C133

17.75" - 24.5"
(45.1 cm - 62.2 cm)



#11001B

#11001BV

#11001BLCD

#11001BG*

#11001B-C133

#11001B-UL



#11001

#11001V

#11001LCD

#11001G*

#11001-C133

#11001-UL

pneumatic
height adjustment

B - backrest
V* - vacuum formed
LCD - locking casters
G - glides
FR - footrest
C133 - CAL-133 upholstery
UL - Ultraleather™ upholstery

*Height range: 16.75" - 23.5"
(42.5 cm - 59.7 cm)

Standard Upholstery Color Selections

For Brewer Tables, Side Chairs, Blood Drawing Chairs and Exam Stools



Clamshell (21) PR 57



Gunmetal (22) PR 92
Vacuum Upholstery DAV 016



Feather (23) PR 37



Black Satin (24) PR 40



Saddle (25) PR 52



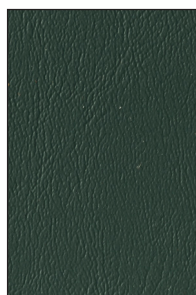
Tapestry Red (26) PR 47



Cabernet (27) PR 36



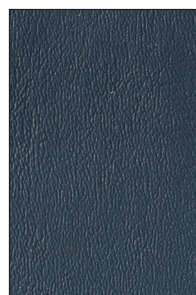
Cocoa (28) PR 51



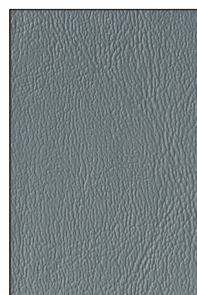
Deep Sea (29) PR 49



Ivy (30) PR 53



Deep Sapphire (31) PR 55



Blue Fog (32) PR 46

California Technical Bulletin 133 Upholstery Color Selections (CAL-133)

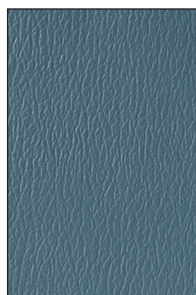
For Brewer Tables, Century Series Stools and Value Plus Series Pneumatic Stools



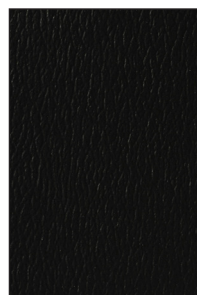
Clamshell PH 57



Almond PH 59



Slate Blue PH 50



Nearly Black PH 64

CAL TB 133 is a written legal standard outlining flammability test procedures for upholstered furniture. These vinyl color selections contain a flame blocking barrier that helps to prevent ignition, reflects heat and is flame retardant.

Premium Plush Upholstery Color Selections

For Brewer Assist Procedure Tables, Access High-Low Exam Tables, Side Chairs and Century Series Stools*



Beech ULU 5638



Arctic (50) UL 5684



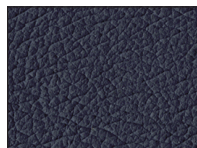
Charcoal (51) UL 5763



Shetland (52) UL 4351



Stone (53) UL 3602



Admiral (55) UL 2556

All Premium Plush Upholstery Colors are Ultrafabrics ULTRALEATHER™.

Note: Tables featuring a plush upholstery top are two-toned, stitched, with Beech and one of the premium plush upholstery colors. Exam stools and side chairs are one solid color, stitched. (-UL)
*Not available for FLEX™ Access Exam Tables

Colors may vary slightly depending on printing settings. For actual material swatches call 1•888•Brewer•1

Additional Standard Upholstery Color Selections

For Brewer Exam Stools Only



Alabaster US 396
Vacuum Upholstery AVS9051



Strato Grey AMB 110



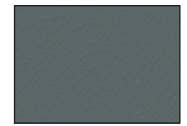
Cloud Grey DUR 006



Dove US 413
Vacuum Upholstery AVS9053



Ash DUR 002
Vacuum Upholstery DAV 011



Greystone US 425



Gunmetal US 392
Vacuum Upholstery DAV 016



Graphite SF 73



Black HAM 114



Clamshell PR 57



Mushroom LV 017



Putty US 403



Taupe DUR 009
Vacuum Upholstery DAV 006



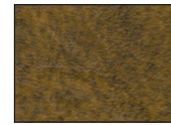
Grey Taupe TL 58



Bone DUR 012



Sand US 384



Buckskin RU 840



Chocolate HAM 122



Claret US 357
Vacuum Upholstery AVS2083



Port NEO 62



Spanish Tile HAM 106



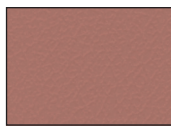
Desert Rose DUR 003
Vacuum Upholstery DAV 007



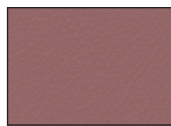
Burgundy US 364



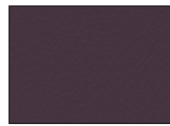
Petal SF 88



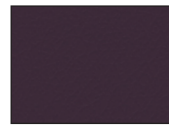
Mauve AM 45



Mauve DUR 018



Purple Grey DUR 007
Vacuum Upholstery DAV 009



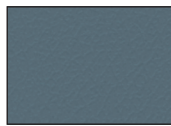
Black Plum CG 3767



Tradewind TL 60



Atlantis DUR 031



Blue Fog PR 46



Agate Blue LV 003



Azure Blue SR 106



Wedgewood DUR 001
Vacuum Upholstery DAV 002



Slate/Yacht Blue NEO 26
Vacuum Upholstery AVS1446



Wedgewood MS 68



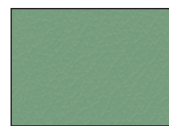
Cobalt DUR 005
Vacuum Upholstery DAV 001



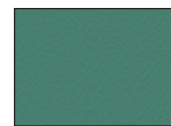
Royal US 354
Vacuum Upholstery AVS9050



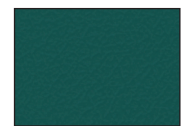
Adriatic (03) DUR 026



Seafoam CG 3550



Dusty Jade DUR 010
Vacuum Upholstery DAV 003



Teal LV 001



Sage HAM 105
Vacuum Upholstery DAV 004



Grey Teal DUR 017



Emerald NEO 40



Forest Green HAM 124



Black US 393
Vacuum Upholstery DAV 013

Colors may vary slightly depending on printing settings. For actual material swatches call 1•888•Brewer•1

The Power to Advance

Founded by E. F. Brewer in 1947, the Brewer Company leads the way in the development of innovative solution through our comprehensive line of power procedure and exam tables as well as the industry's first mobile patient lift, the Brewer LiftMate™.

Our process-oriented solutions are designed to help you safely meet the patient handling needs of individuals with mobility issues as well as improve operational efficiencies while more effectively protecting patients and staff.

Whether it's an aging population, obese patients, pregnant women or those with an injury or physical disability, Brewer provides the practical, common-sense approaches to today's do-more-with-less demands that you won't find anywhere else.

What's more, our tables and patient lift products are proudly made in the USA. Our extensive line of solutions is manufactured to Brewer's rigorous quality standards and backed by best-in-class standard warranties. It's all part of our commitment to provide you with The Power to Advance. Safely. Financially. Competitively.

Brewer

The Power to Advance

The Brewer Company, LLC
N88W13901 Main Street, Suite 100
Menomonee Falls, WI 53051

P 1.888.Brewer.1

F 262.251.2332

www.brewercompany.com

