

Replacing Backrest Upright Bar

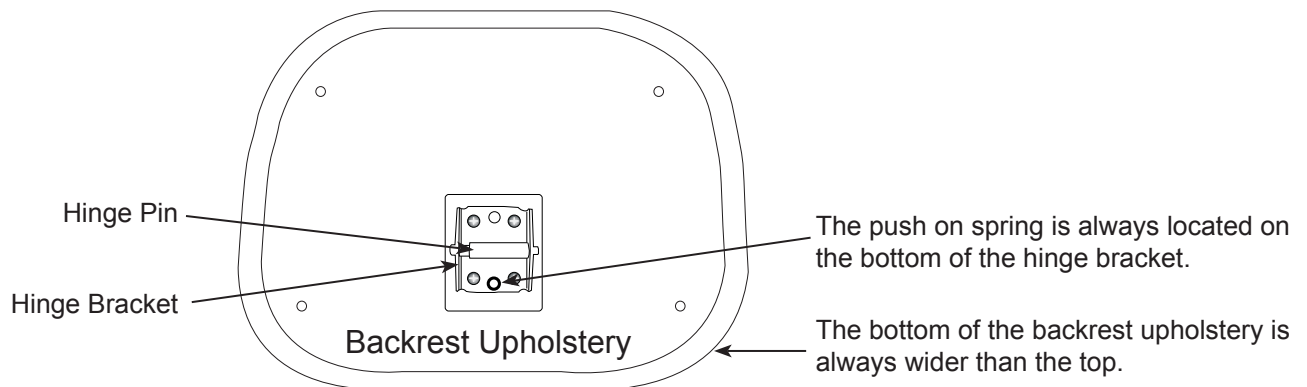

Item	Description	Qty
1	Backrest Upright Bar with Knob, Star Washer and Bellville Washer	1
2	Spring, Backrest Hinge (tilts backrest)	1
*3	Screw, Backrest Shroud, #6 X 1.75"	2
*4	Screw, Backrest Shroud, #6 X 1"	2

Tools Needed-Philips Screwdriver, Ballpoint Pen (with point retracted).



Component Identification

*Note: your upholstery may appear different from the one shown in these instructions. The procedure is the same for all backrest upholstery that uses the type of hinge bracket shown. Instructions show Backrest Shroud Screws that may not be included in your kit.

Replacing Backrest Upright Bar

Removing the Backrest Upright Bar

1. Remove Backrest Upright Bar from Control Plate by removing Handknob, Star Washer and Bellville Washer. Note: hold Backrest Upright Bar with other hand to prevent Backrest assembly from falling out.

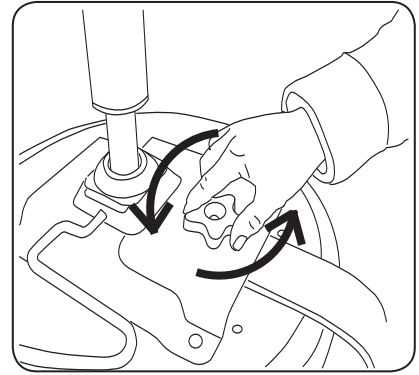

2. If the Backrest Upright Bar passes through a hole at the bottom of the Backrest Shroud, perform this step. Otherwise go to step 4. Place Backrest Upholstery vinyl side down on clean work surface, and remove the four screws that secure the Backrest Shroud to the Backrest.

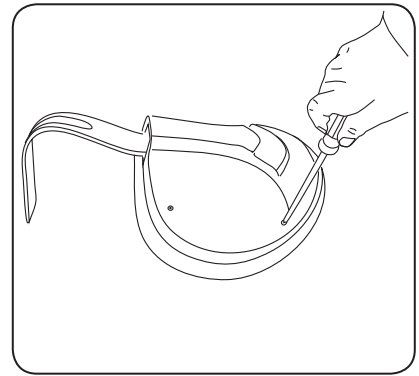

3. Slide the Backrest Shroud off of the Backrest Upright Bar.

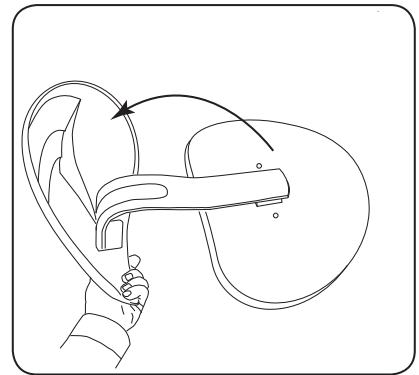

4. Place Backrest Upholstery vinyl side down onto clean work surface.
5. Press the hinge pin in to release it from the Hinge Bracket (using a ball point pen with the point retracted works well). To prevent injury do not use a sharp object.
6. Rotate the Backrest Upright Bar sideways as shown.

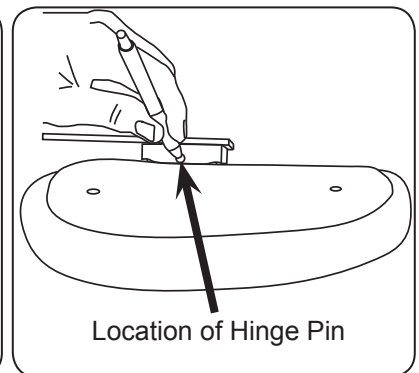
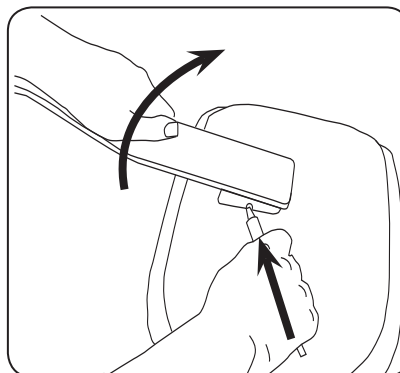

Replacing Backrest Upright Bar

7. Press other hinge pin in to release Backrest Upright Bar from Backrest Upholstery.

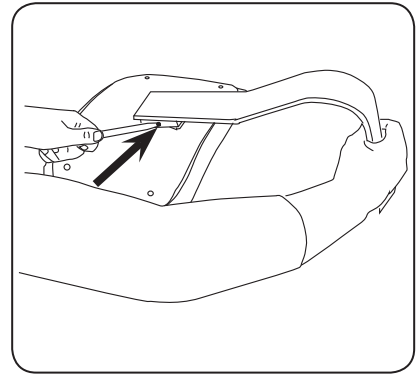

Installing the Backrest Upright Bar

1. Install new spring on bottom spring holder on Hinge Bracket. Press Spring firmly onto Hinge Bracket. Note: This can take a significant amount of force to press on.
2. Bring Backrest Upright Bar straight down onto Hinge Bracket to ensure alignment of Backrest Hinge Spring.
3. Rotate Backrest Upright Bar to one side to allow Hinge Pin to pass through one hole in the mating bracket.

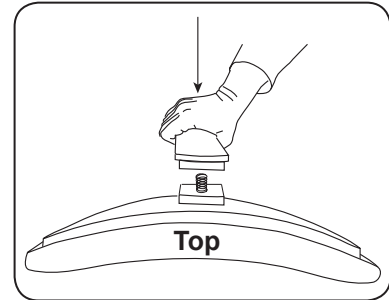
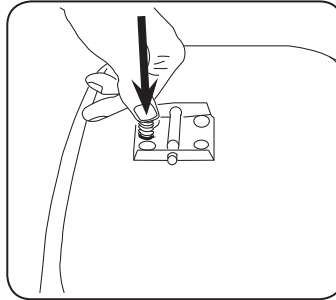

4. Rotate Backrest Upright Bar in other direction to allow other side of the Hinge Pin to pass through other hole in mating bracket. Note: pin may need to be pushed in to clear the edge of the mating bracket.

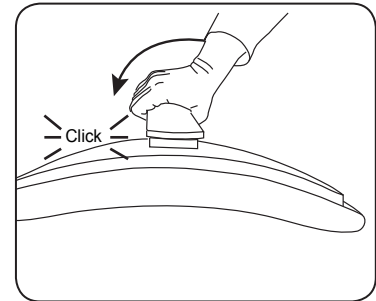
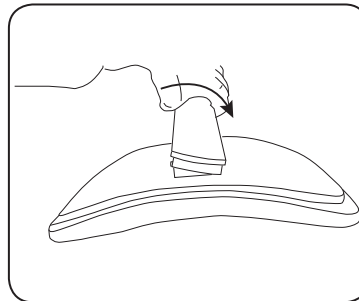

5. Backrest assembly may now be reattached to Control Plate with Handknob. The order of the washers on the Handknob is important-see diagram on far right.

