

Knob Replacement Instructions

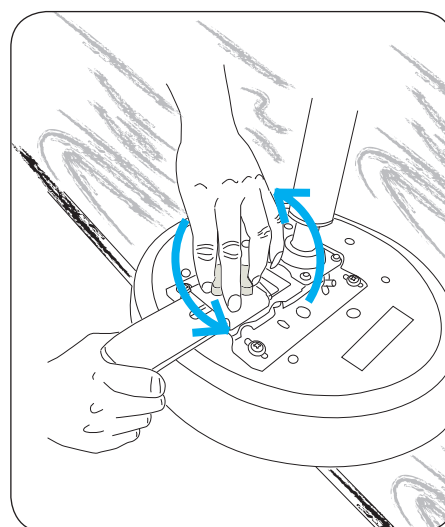

Item No.	Description	Qty
1	Knob, Star Washer, and Bellville Washer	1

1. Set stool upside down on a clean smooth work surface. Allow backrest to hang down over edge of work surface. Make sure entire seat is placed onto work surface to prevent stool from tipping and falling off.
2. Unscrew old knob from control plate.
3. Discard old knob and washers.



4. Place star washer, concave washer round-ed side up, and knob in the order shown,.
5. Insert knob with washers through opening in control plate, and screw into backrest upright bar to secure backrest upright.

